



COUPLING RELAY IM INDUSTRY-STANDARD
ENCLOSURE 2 CHANGEOVER CONTACTS WIDE
VOLTAGE RANGE 24 V TO 240 V AC/DC SCREW
TERMINALS

General technical details:

Type of voltage		AC/DC
Supply voltage frequency		
<ul style="list-style-type: none"> • 1 / for auxiliary and control current circuit <ul style="list-style-type: none"> • rated value 	Hz	50
<ul style="list-style-type: none"> • 2 / for auxiliary and control current circuit <ul style="list-style-type: none"> • rated value 	Hz	60
Control supply voltage / 1		
<ul style="list-style-type: none"> • at 50 Hz / for AC <ul style="list-style-type: none"> • initial rated value • final rated value • at 60 Hz / for AC <ul style="list-style-type: none"> • initial rated value • final rated value • for DC <ul style="list-style-type: none"> • initial rated value • final rated value 	V	24
	V	240
	V	24
	V	240
	V	24
	V	240
Switching behaviour		monostable
Product component / jumper socket		No
Reference code / according to DIN EN 61346-2		K

Reference code / according to DIN 40719 extended according to IEC 204-2 / according to IEC 750

K

Mechanical design:

Design of the electrical connection		screw-type terminals
Design of the electrical connection / jumper socket		No
Design of the relay operating mechanism		poled
Design of the switching function		changeover switch
• guided		No
Width	mm	22.5
Height	mm	92
Depth	mm	91

Auxiliary Contacts:

Number of NC contacts / for auxiliary contacts		0
Number of NO contacts / for auxiliary contacts		0
Number of changeover contacts / for auxiliary contacts		2
Current carrying capacity / of output relay		
• at DC-13		
• at 24 V	A	1
• at 125 V	A	0.2
• at 250 V	A	0.1
• at AC-15 / at 250 V	A	3

Ambient conditions:

Protection class IP		IP20
Ambient temperature / during operating / minimum	°C	-25
Ambient temperature / during operating / maximum	°C	60

Certificates/approvals:

General Product Approval

other



CCC



UL

[Declaration of Conformity](#)

[other](#)

[Environmental Confirmations](#)

Further information:

Information- and Downloadcenter (Catalogs, Brochures,...)

<http://www.siemens.com/industrial-controls/catalogs>

Industry Mall (Online ordering system)

<http://www.siemens.com/industrial-controls/mall>

CAX-Online-Generator

<http://www.siemens.com/cax>

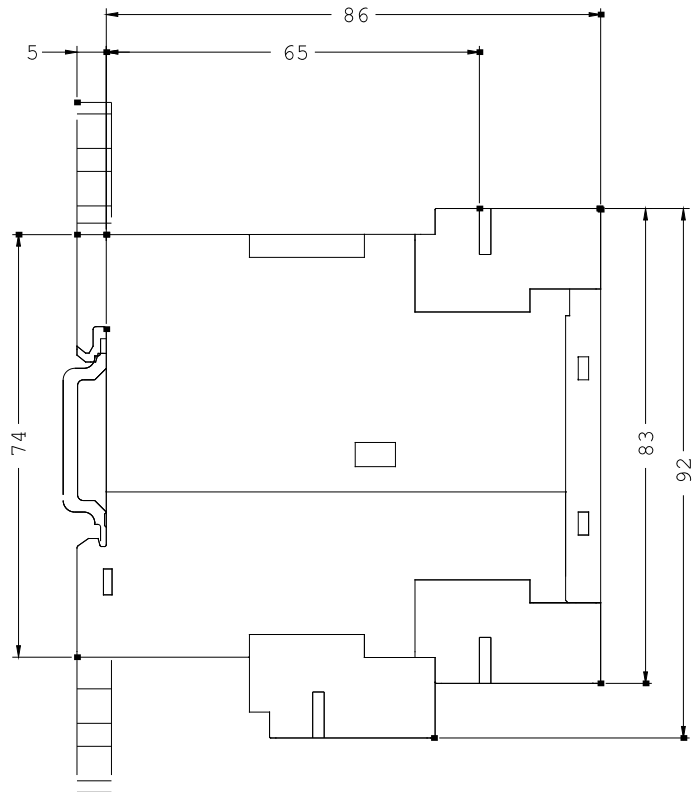
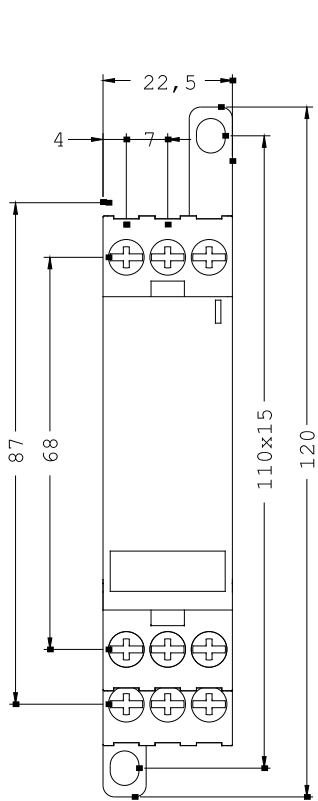

last change:

Jun 16, 2014