



Accessories - Panels
Surface Shield
Panels SFA-Series



Design Features

White, pressure-sensitive paper on one side protects and provides surface for laying out drilling or punching positions. Mill finish aluminum alloy panels. Available in .12" and .18" thickness, 19" Width.

Surface Shield							
0.12" Thick				0.18" Thick			
Catalog No.	Drawings	Height	Weight Lbs.	Catalog No.	Drawings	Height	Weight Lbs.
SFA-1831		1.75"	.37	SFA-3161		1.75"	.75

SFA-1832	3.50"	.75	SFA-3162	3.50"	1.25
SFA-1833	5.25"	1.12	SFA-3163	5.25"	1.75
SFA-1834	7.00"	1.75	SFA-3164	7.00"	2.50
SFA-1835	8.75"	2.00	SFA-3165	8.75"	3.00
SFA-1836	10.50"	2.50	SFA-3166	10.50"	3.75
SFA-1837	12.25"	2.75	SFA-3167	12.25"	4.50
SFA-1838	14.00"	3.25	SFA-3168	14.00"	5.00
SFA-1839	15.75"	3.62	SFA-3169	15.75"	5.75
SFA-1840	17.50"	4.00	SFA-3170	17.50"	6.25
SFA-1841	19.25"	4.25	SFA-3171	19.25"	7.00
SFA-1842	21.00"	5.00	SFA-3172	21.00"	7.25



PART NAME

RELAY RACK PANELS

PART No.

PA-1101 THRU PA-1112 / PS-1250 THRU PS-1261
SFA-1831 THRU SFA-1842

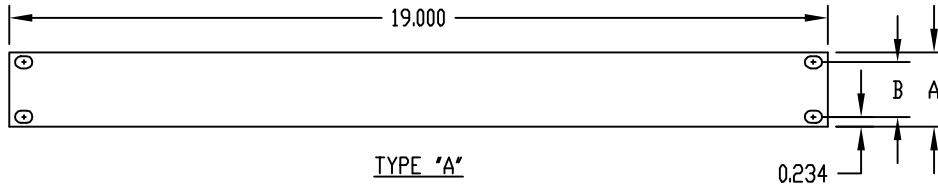

TYPE 'A'

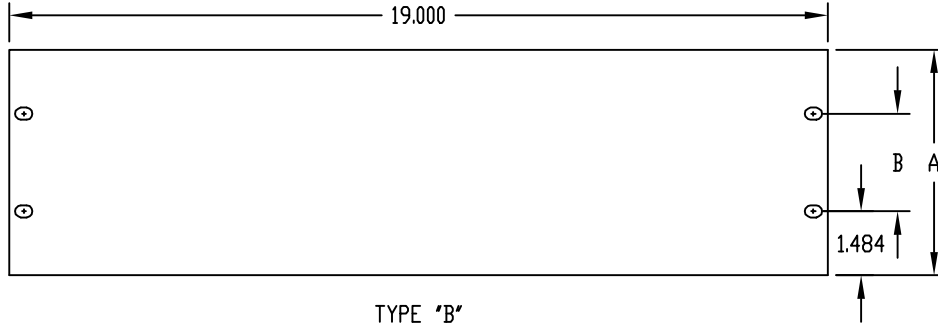

TYPE 'B'

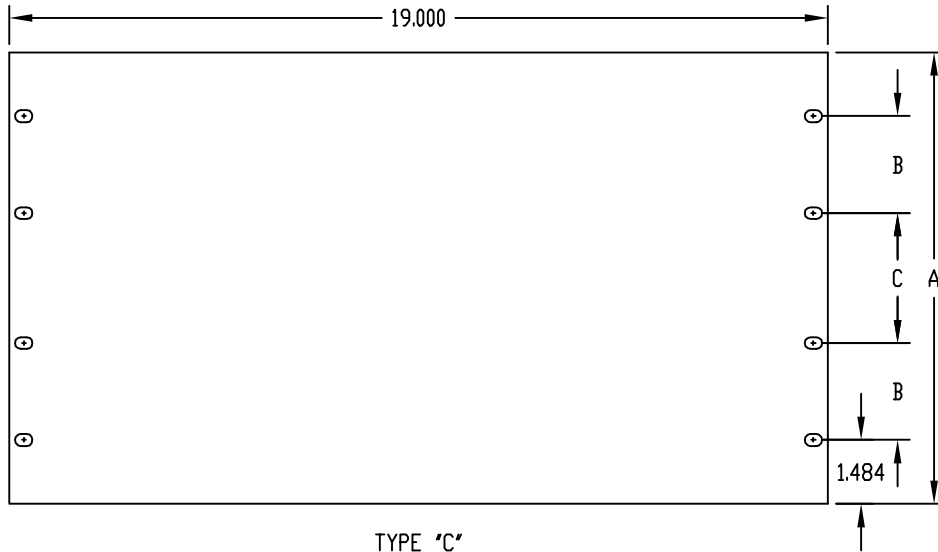

TYPE 'C'

'PA' SERIES:

MATERIAL: 0.125 ALUMINUM
FINISH: METALLIC GRAY
WHITE TEXTURED
BLACK TEXTURED

'PS' SERIES:

MATERIAL: 11 GA. STEEL
FINISH: METALLIC GRAY
WHITE TEXTURED

'SFA' SERIES:

MATERIAL: 0.125 ALUMINUM
ONE SIDE TAPED
FINISH: NATURAL

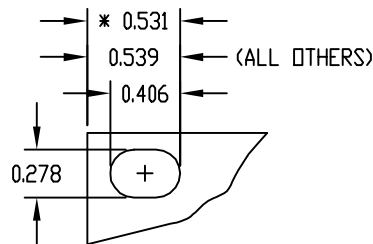

NOTCH DETAIL

* - THIS DIMENSION APPLIES TO ONLY
PA-1101 & PA-1102
SFA-1831 & SFA-1832

'PA' SERIES	'PS' SERIES	'SFA' SERIES	TYPE	A	B	C
PA-1101	PS-1250	SFA-1831	A	1.750	1.250	-
PA-1102	PS-1251	SFA-1832	A	3.500	3.000	-
PA-1103	PS-1252	SFA-1833	B	5.250	2.250	-
PA-1104	PS-1253	SFA-1834	B	7.000	4.000	-
PA-1105	PS-1254	SFA-1835	B	8.750	5.750	-
PA-1106	PS-1255	SFA-1836	C	10.500	2.250	3.000
PA-1107	PS-1256	SFA-1837	C	12.250	3.500	2.250
PA-1108	PS-1257	SFA-1838	C	14.000	4.000	3.000
PA-1109	PS-1258	SFA-1839	C	15.750	4.000	4.750
PA-1110	PS-1259	SFA-1840	C	17.500	4.000	6.500
PA-1111	PS-1260	SFA-1841	C	19.250	5.250	5.750
PA-1112	PS-1261	SFA-1842	C	21.000	5.250	7.500