

BOH TR-T48-001-TL-00,1  
BOH001E

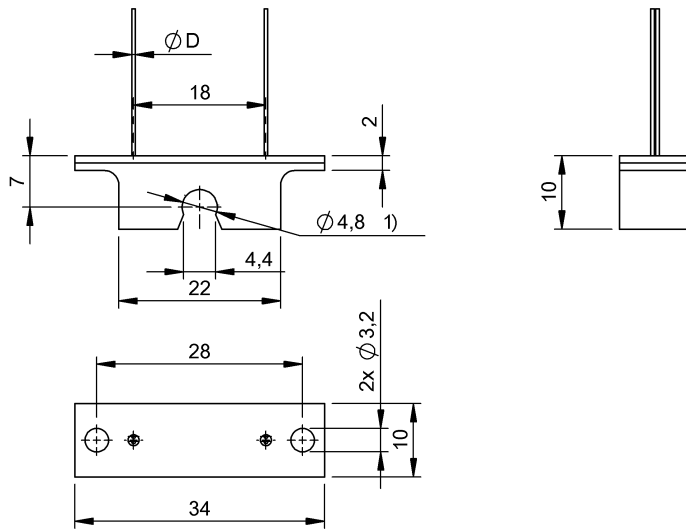

1) Hose fitting



## Electrical connection

Cable diameter D	0.60 mm
Cable length	0.1 m
Conductor cross-section	AWG 32
Connection type	Leads, 0.10 m, PTFE
Number of conductors	4

## Environmental conditions

Ambient temperature	-10...60 °C
Protection type IEC 60529	IP65

## General data

Application	Tube sensor Liquid sensing
Approval/Conformity	CE
Basic standard	IEC 60947-5-2
Reference base unit	BAE SA-OH-029-...
Series	T48
Style	Tube sensor Connection 90°

## Material

Housing material	Aluminum
Material jacket	PTFE, Individual leads

Material sensing surface  
Surface protection

Epoxy  
anodized, black

## Mechanical data

Dimension	34 x 10 x 10 mm
Fastening detail	Screw M3
Fork opening	for tube Ø 4.8 mm

## Optical data

LED group per IEC 62471	Exempt Group
Light type	LED Red light
Principle of optical operation	Fork sensor
Special optical feature	Diffraction caused by liquid
Wave length	665 nm

## Output/Interface

Switching output	for switching amplifier
------------------	-------------------------

## Remarks

The optical properties of the tube and its wall thickness can affect the signal amplitude.  
Use only transparent tubes with sensor.  
For additional information, refer to user's guide.

BOH TR-T48-001-TL-00,1  
BOH001E

## Symbols for Optoelectronic Sensors

