

BCS R08RR01-NSM80C-EP00,2-GS49 BCS0057

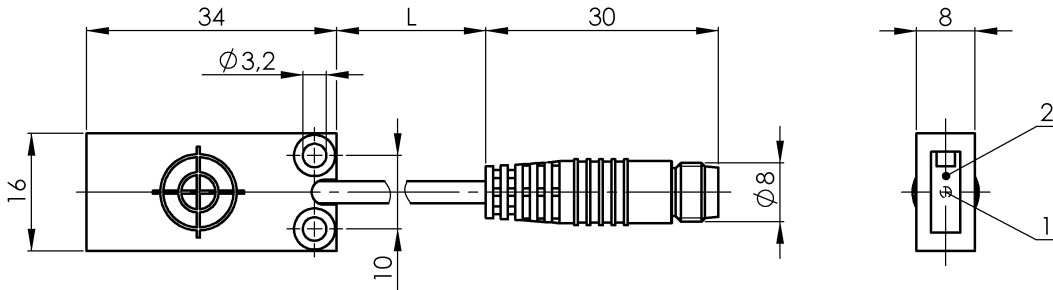

1) Potentiometer 2) LED function indicator



Electrical connection

Cable length	0.2 m
Connection	M8x1-Connector, 3-pole
Connection type	Cable with connector, 0.20 m, PUR
Polarity reversal protected	yes
Short-circuit protection	yes

Electrical data

Hysteresis H max. (% of Sr)	15.0 %
MTTF (40 °C)	680 a
Operating voltage U_b	12...30 VDC
Protected against miswiring	yes
Rated insulation voltage U_i	75 V DC
Rated operating current I_e DC	50 mA
Ready delay t_v max.	100 ms
Repeat accuracy max. (% of Sr)	5.0 %
Switching frequency	100 Hz
Utilization category	DC -13
Voltage drop static max.	1.5 V

Environmental conditions

Ambient temperature	-30...70 °C
Protection type IEC 60529	IP67

Functional safety

Diagnostic coverage	0 %
Functional safety	no

General data

Approval/Conformity	CE cULus
Basic standard	IEC 60947-5-2
Sensitivity	Switching distance adjustable

Material

Cover material	PP
Housing material	PP
Material cover	PP
Material jacket	PUR
Material sensing surface	PP

Mechanical data

Dimension	34 x 16 x 8 mm
Installation	for flush mounting

Output/Interface

Switching output	NPN Normally open (NO)
------------------	------------------------

Range/Distance

Measuring range	1...8 mm
Range	1...8 mm
Rated operating distance S_n	8 mm
Ripple max. (% of U_e)	10 %
Temperature drift max. (% of Sr)	20 %

BCS R08RR01-NSM80C-EP00,2-GS49 BCS0057

For further information on MTTF/B10d, please refer to the MTTF / B10d Certificate.

Specification of the MTTF value and the B10d value do not represent any binding quality and/or life expectancy guarantees.

Connector view

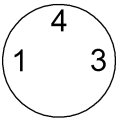

Wiring Diagram

