

BFO 18A-LCC-SMG-20-0,5 BFO000U

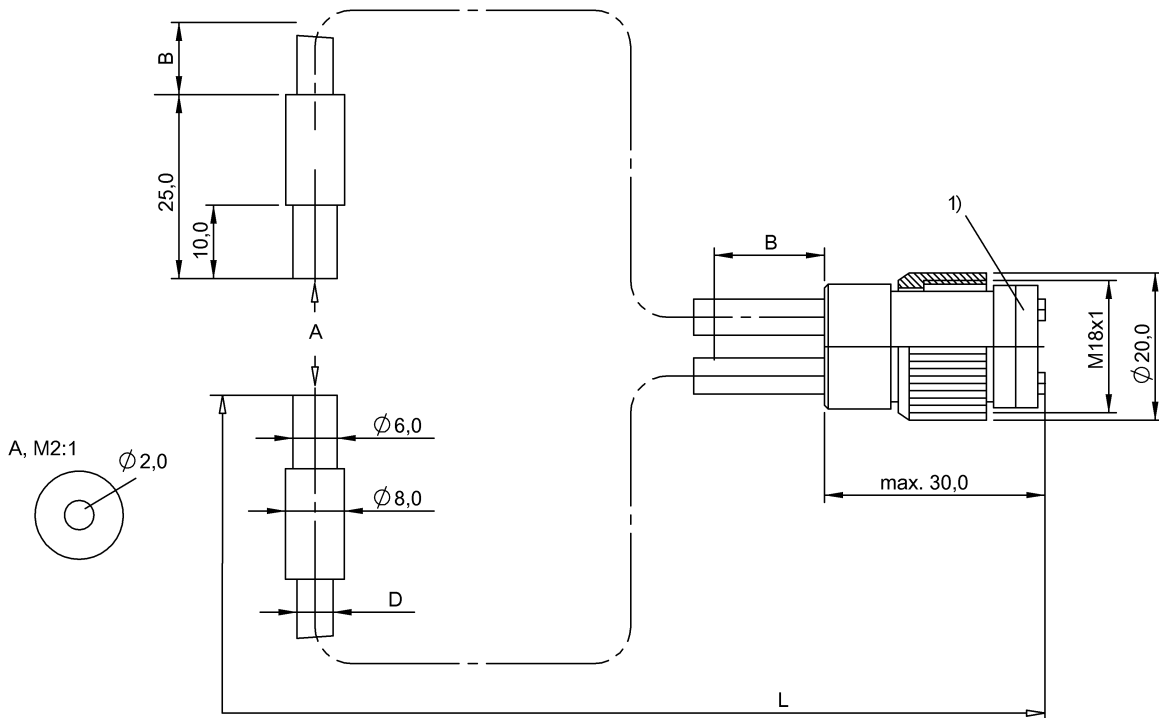

1) Disc removable

Electrical connection

Cable diameter D	6.50 mm
Cable length	0.5 m
Connection	M18x1
Connection type	Adapter head, 0.50 m, Silicone

Electrical data

Active surface, fibers	Bundle Ø 1.0 mm
------------------------	-----------------

Environmental conditions

Ambient temperature	-40...150 °C
Ambient temperature connection area	-5...55 °C
Ambient temperature max.	150 °C static/dynamic
Ambient temperature min.	-40 °C static, 0 °C dynamic
Protection type IEC 60529	IP67

General data

Basic standard	IEC 60947-5-2
Reference base unit	BFB M18M-011-P-S4
Scope of delivery	Fiber optic cable (1x)

Version

Ø 6, standard

Material

Active surface, fiber arrangement	Homogeneous bundle
Fiber type material	Glass
Housing material	Brass
Material jacket	Silicone, on stainless steel
Surface protection	blackened

Mechanical data

Cable, bending radius min.	60 mm
Dimension	Ø 8 x 25 mm
Fastening detail	Clamped
Fiber optic cable, structure	Metal spiral in plastic jacket Fiber bundle in metal coil
Tensile load max. at 20 °C	45 N

Optical data

Principle of optical operation	Through-beam sensor
--------------------------------	---------------------

BFO 18A-LCC-SMG-20-0,5 BFO000U

Range/Distance

Effective operating distance S_r	200 mm
Range	200 mm
Rated operating distance S_n	200 mm

Remarks

Order accessories separately.
Route fiber optic cable so that no excessive tensile, compression or torsional forces are permitted. Observe permissible bending radiuses. Installation may affect the switching distance.
Actuation object (target): gray card, 200 x 200, lateral approach

Symbols for Optoelectronic Sensors

