

REV	DATE	DESCRIPTION	APP

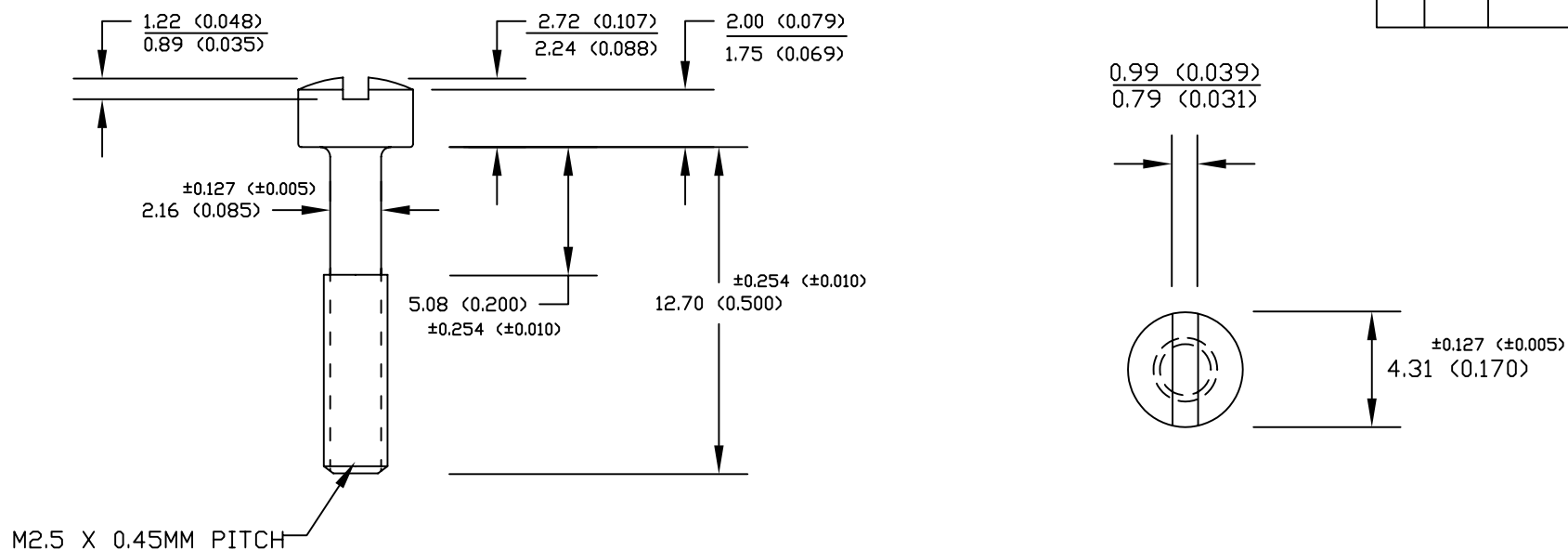

NOTES:

1. ISO STANDARD SERIES M2.5 X .45MM PITCH, MEDIUM FIT THREAD
2. MATERIAL: 12L14 FREE-MACHINING STEEL
3. FINISH: BRIGHT ZINC (TRIVALENT CHROMATE PLATING)
4. DIMENSIONS - SHOWN AS MM (INCHES)
5. MAKE PART COMPLIANT TO:
EU DIRECTIVE 2002/95/EC
OF 27 JANUARY 2003 [RoHS]

Limiting Dimensions of M2.5 X 0.45 External Thread Screw-Class 6g (Dimensions In MM)							
Major Diameter			Pitch Diameter			Minor Diameter	
Max	Min	Tol	Max	Min	Tol	Flat Form Max	Rounded Form Min
2.480	2.380	0.100	2.188	2.117	0.071	1.993	1.840

THIS IS A CONTROLLED DOCUMENT AND IS SUBJECT TO CHANGE. CONTACT NORTHERN TECHNOLOGIES ENGINEERING FOR THE LATEST REVISION.

UNLESS OTHERWISE SPECIFIED	SIGNATURES	DATE	Northern Technologies		THIS DRAWING IS THE PROPERTY OF NORTHERN TECHNOLOGIES AND SHOULD NOT BE REPRODUCED WITHOUT NORTHERN TECHNOLOGIES WRITTEN PERMISSION.
1. ALL DIMENSIONS ARE IN INCHES (MM) 2. DIMENSIONS ARE TYPICAL	DRAWN JSD	01-AUG-05	PART NUMBER B71E3005134M25S		
	CHECKED SCN	01-AUG-05	DESCRIPTION M2.5 X 1/2" CAPTIVE SCREW (MACHINED) [RoHS]		
	ISSUED	01-AUG-05	SHEET	CODE 520_179	DWG NO. 0002-520-179
			SCALE N.T.S.		SHEET 1 OF 1