

SPECIFICATIONS	
CONTACT CARRIER MATERIAL/COLOR (J2,P2)	NYLON or TPU/BLACK
MOLDED HEAD MATERIAL/COLOR	TPU/BLACK
CONTACT MATERIAL/PLATING	BRASS/GOLD
COUPLING NUT MATERIAL/FINISH	STAINLESS STEEL/PASSIVATED
OUTER JACKET MATERIAL/COLOR	PVC/VIOLET
CONDUCTOR INSULATION MATERIAL	POLYETHYLENE
NUMBER OF CONDUCTORS [AWG]	2x22 AWG (SHIELDED DATA PAIR WITH DRAIN WIRE)
DRAIN/SHIELD	22 AWG/ALUM. MYLAR AND TINNED-COPPER, BRAIDED
TEMPERATURE RANGE (D9S)	0°C to 60°C (32°F to 140°F)
PROTECTION CLASS	NEMA 1,3,4,6P AND IEC IP68 (IP20 (D9SM))
PROFIBUS TERMINATING RESISTOR	YES
MAX. PANEL THICKNESS	3.0mm [0.12"] (P2), 5.5mm [0.216"] (J2)

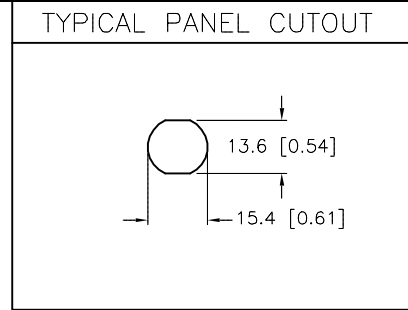
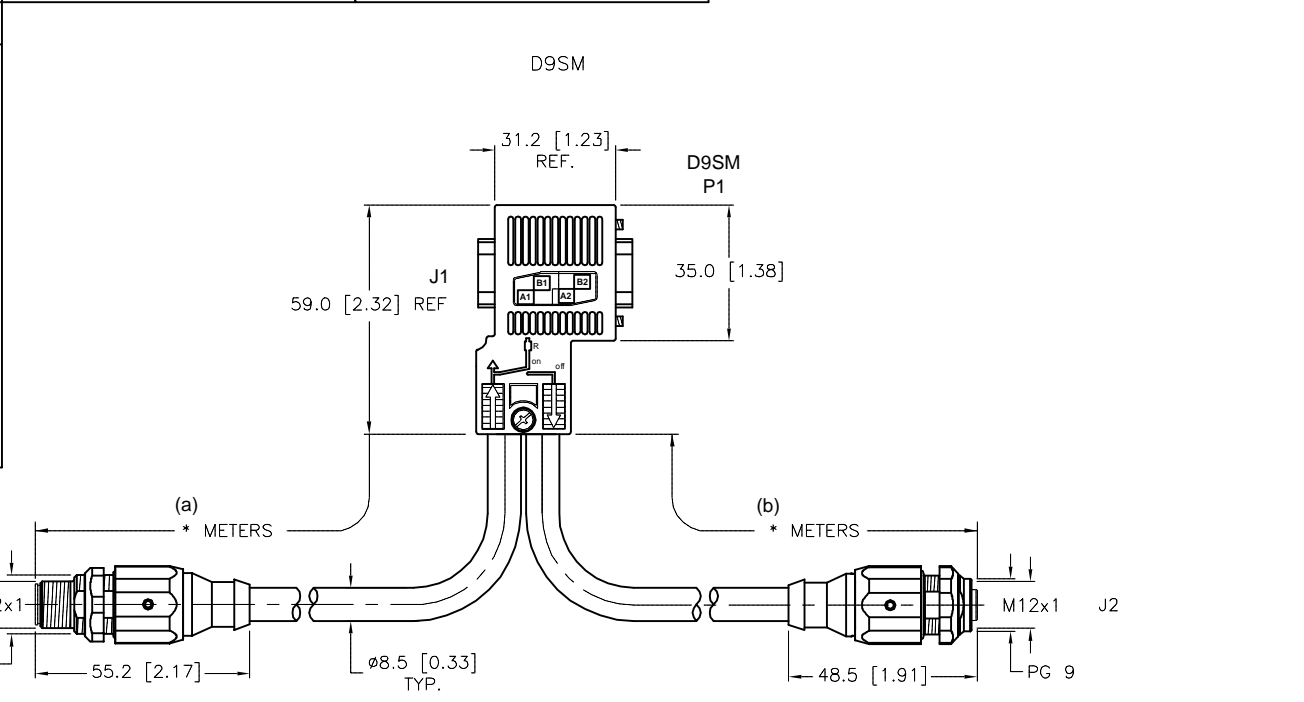
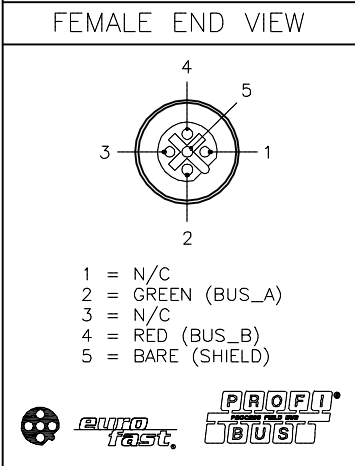

CABLE LENGTH	TOLERANCE*
ALL LENGTHS	+ 4% (OR 50mm) OF LENGTH - 0% (OR 0mm) OF LENGTH WHICHEVER IS GREATER
STRIP LENGTH	TOLERANCE*
0-7mm	±0.5mm
8-29mm	±1.0mm
30-49mm	±2.0mm
50-69mm	±3.0mm
70-100mm	±4.0mm
OVER 100mm	±5.0mm

**\* UNLESS OTHERWISE SPECIFIED**

**SOURCE DRAWING - FOR REFERENCE ONLY**

NOTES:

1. "\*" INDICATES CABLE LENGTH IN METERS. CONTACT TURCK TO ORDER SPECIFIC LENGTHS.

E	REMOVE RATED CURRENT AND VOLTAGE	CK	05/03/11	34896
REV	DESCRIPTION	BY	DATE	ECO NO.

RELATED DOCUMENTS 1. 2. 3. 4.	3RD ANGLE PROJECTION 	THIS DRAWING IS CONFIDENTIAL AND THE PROPERTY OF TURCK INC. USE OF THIS DOCUMENT WITHOUT WRITTEN PERMISSION IS PROHIBITED.		3000 CAMPUS DRIVE MINNEAPOLIS, MN 55441 1-800-544-7769 (763) 553-7300 (763) 553-0708 fax turck.com
		DRFT RDS APVD	DATE 11/07/06 SCALE 1=2.0	
MATERIAL	ALL DIMENSIONS DISPLAYED ON THIS DRAWING ARE FOR REFERENCE ONLY	UNIT OF MEASUREMENT <b>MILLIMETER [ INCH ]</b>		IDENTIFICATION NO.
FINISH		CONTACT TURCK FOR MORE INFORMATION	DO NOT SCALE THIS DRAWING	REV <b>E</b>
FILE: 777014421			SHEET 1 OF 1	