



TEMPERATURE MONITORING RELAY PT100/1000  
 KTY83/84,  
 NTC, 2 THRESHOLDS, DIGITAL,  
 -50 DEGREES C TO 750 DEGREES C (SENSOR-  
 DEPENDENT),  
 24 V TO 240 V AC/DC, 2 X 1 CO + 1 NO,  
 WIDTH 45 MM, SCREW TERMINAL

**General technical details:**



<b>type of voltage</b>		AC/DC
<b>Supply voltage frequency</b>		
<ul style="list-style-type: none"> <li>• 1 / for auxiliary and control current circuit</li> <li> <ul style="list-style-type: none"> <li>• initial rated value</li> <li>• final rated value</li> </ul> </li> <li>• 1 / at 50 Hz / for AC / initial rated value</li> <li>• 1 / at 50 Hz / for AC / final rated value</li> <li>• 1 / at 60 Hz / for AC / initial rated value</li> <li>• 1 / at 60 Hz / for AC / final rated value</li> <li>• 1 / for DC / initial rated value</li> <li>• 1 / for DC / final rated value</li> </ul>	<ul style="list-style-type: none"> <li>Hz</li> <li>Hz</li> <li>V</li> <li>V</li> <li>V</li> <li>V</li> <li>V</li> <li>V</li> </ul>	<ul style="list-style-type: none"> <li>50</li> <li>60</li> <li>24</li> <li>240</li> <li>24</li> <li>240</li> <li>24</li> <li>240</li> </ul>
<b>Number of measuring circuits</b>		1
<b>Product function</b>		
<ul style="list-style-type: none"> <li>• defect storage</li> <li>• reset external</li> </ul>		<ul style="list-style-type: none"> <li>Yes</li> <li>Yes</li> </ul>
<b>Measurable temperature</b>		
<ul style="list-style-type: none"> <li>• initial value</li> <li>• final value</li> </ul>	<ul style="list-style-type: none"> <li>°C</li> <li>°C</li> </ul>	<ul style="list-style-type: none"> <li>-50</li> <li>750</li> </ul>
<b>Item designation / according to DIN EN 61346-2</b>		K

Item designation / according to DIN 40719 extendable after IEC 204-2 / according to IEC 750		K
Ambient temperature • during operating	°C	-25 ... +60

### Mechanical design:

Design of the electrical connection • for auxiliary and control current circuit • jumper socket		screw-type terminals Yes
Design of the sensor / connectable		PT100/1000, KTY83/84, NTC (resistance sensors)
Number of NC contacts / for auxiliary contacts		0
Number of NO contacts / for auxiliary contacts		1
Number of change-over switches / for auxiliary contacts		2
Width	mm	45
Height	mm	106
Depth	mm	91

### Certificates/approvals:

General Product Approval	other
 CCC  GOST  UL	<a href="#">Declaration of Conformity</a> <a href="#">Environmental Confirmations</a>

### Further information:

<b>Information- and Downloadcenter (Catalogs, Brochures,...)</b> <a href="http://www.siemens.com/industrial-controls/catalogs">http://www.siemens.com/industrial-controls/catalogs</a>
<b>Industry Mall (Online ordering system)</b> <a href="http://www.siemens.com/industrial-controls/mall">http://www.siemens.com/industrial-controls/mall</a>
<b>Cax online generator:</b> <a href="http://www.siemens.com/cax">http://www.siemens.com/cax</a>
<b>Service&amp;Support (Manuals, Certificates, Characteristics, FAQs,...)</b> <a href="http://support.automation.siemens.com/WW/view/en/3RS1042-1GW70/all">http://support.automation.siemens.com/WW/view/en/3RS1042-1GW70/all</a>
<b>Image database (product images, 2D dimension drawings, 3D models, device circuit diagrams, ...)</b> <a href="http://www.automation.siemens.com/bilddb/cax_en.aspx?mlfb=3RS1042-1GW70">http://www.automation.siemens.com/bilddb/cax_en.aspx?mlfb=3RS1042-1GW70</a>

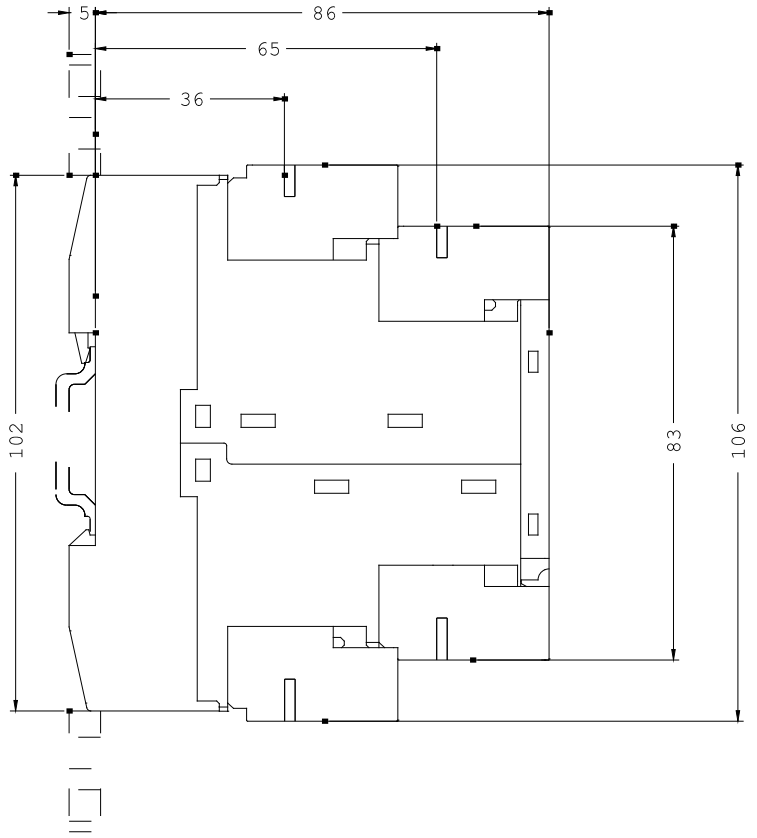
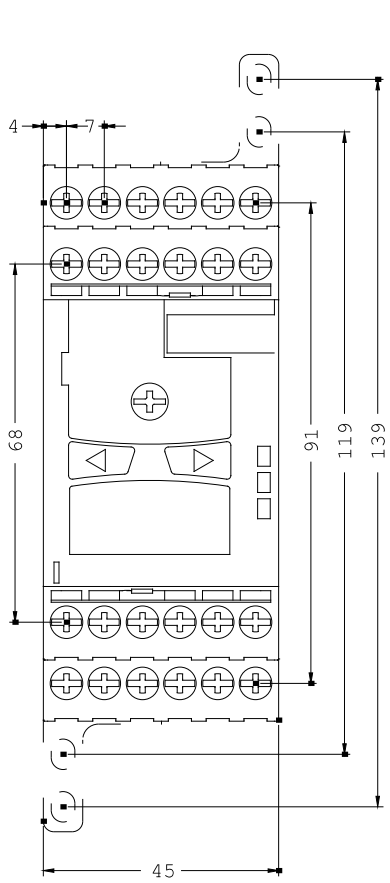

last change:

Jan 25, 2013