

## BAW M30ME-UAC10B-S04G BAW002W

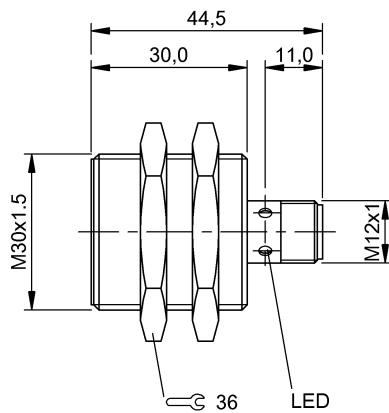

IND. CONT. EQ  
8TU2  
for use in the secondary of  
a class 2 source of supply  
Environmental - Type 1 Enclosure



### Display/Operation

Function indicator	Adjustment indicator
Power indicator	no

### Electrical connection

Connection	M12x1-Connector, 4-pole, A-coded
Polarity reversal protected	yes
Short-circuit protection	yes

### Electrical data

MTTF (40 °C)	640 a
No-load current $I_0$ max. at $U_e$	10 mA
Operating voltage $U_b$	15...30 VDC
Pollution degree	3
Protected against miswiring	yes
Rated insulation voltage $U_i$	250 V AC
Rated operating voltage $U_e$ DC	24 V
Slope U	1.25 V/mm

### Environmental conditions

Ambient temperature	-10...70 °C
Protection class	II
Protection type IEC 60529	IP67

### Functional safety

Diagnostic coverage	0 %
Functional safety	no
Mission Time	20 a

### General data

Approval/Conformity	CE cULus EAC
Basic standard	BWN PR 44 IEC 60947-5-2 IEC 60947-5-7

### Material

Housing material	Brass
Material sensing surface	PBT
Surface protection	nickel plates

### Mechanical data

Dimension	Ø 30 x 44.5 mm
Installation	for flush mounting
Size	M30x1.5
Tightening torque	70 Nm

### Output/Interface

Analog output	Analog, voltage, Voltage falling on approach
---------------	--

### Range/Distance

Measuring range	2...10 mm
Non-linearity max.	±240 µm
Range	2...10 mm
Repeat accuracy	3.0 % FS
Ripple max. (% of $U_e$ )	15 %

## BAW M30ME-UAC10B-S04G BAW002W

### Remarks

When used in Balluff clamping holders,  $U_a$  may be reduced by max. 10%  
 With connector, e.g. BKS-S 20-... total length = switch length + 18 mm.  
 Shock: Half-sinus, 30 gn, 11 ms, number: 3x12, continuous shock, half-sinus,  
 100 gn, 2 ms, number: 3x8000.  
 Values referenced to axial approach of St 37 target. For other materials  
 correction factors are applied.

For further information on MTTF/B10d, please refer to the MTTF / B10d Certificate.

Specification of the MTTF value and the B10d value do not represent any binding quality and/or life expectancy guarantees.

### Connector view



### Wiring Diagram

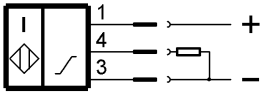

### Diagram

