

FEMALE END VIEW

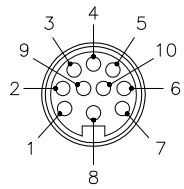

- 1 = WHITE/BLACK
- 2 = BLACK/WHITE
- 3 = WHITE/GREEN
- 4 = GREEN/WHITE
- 5 = WHITE/RED
- 6 = RED/WHITE
- 7 = GRAY
- 8 = GREEN/YELLOW
- 9 = WHITE/ORANGE
- 10 = ORANGE/WHITE



SPECIFICATIONS

|                                |                                   |
|--------------------------------|-----------------------------------|
| CONTACT CARRIER MATERIAL/COLOR | POLYURETHANE/YELLOW               |
| CONTACT MATERIAL/PLATING       | BRASS/GOLD                        |
| HOUSING MATERIAL/FINISH        | STAINLESS STEEL/PASSIVATED        |
| RATED CURRENT [A]              | 8.0 A                             |
| RATED VOLTAGE [V]              | 600 V                             |
| CONDUCTOR INSULATION MATERIAL  | PVC                               |
| NUMBER OF CONDUCTORS [AWG]     | 10x18 AWG                         |
| TEMPERATURE RATING             | -40°C to +105°C (-40°F to +221°F) |
| PROTECTION CLASS               | MEETS NEMA 1,3,4,6P AND IEC IP67  |

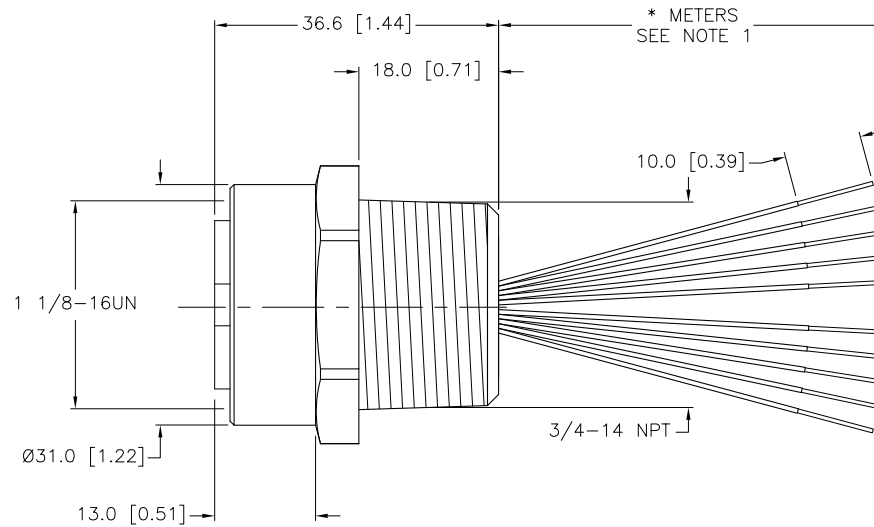
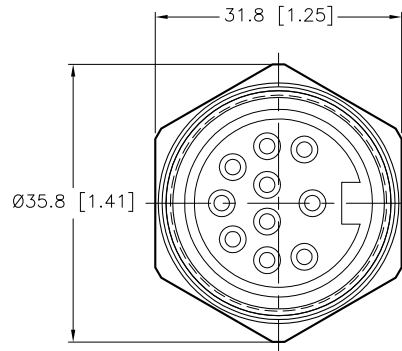

| CABLE LENGTH | TOLERANCE   |
|--------------|---|
| ALL LENGTHS  | + 4% (OR 50mm) OF LENGTH<br>- 0% (OR 0mm) OF LENGTH<br>WHICHEVER IS GREATER |
| STRIP LENGTH | TOLERANCE   |
| 0-7mm        | ±0.5mm  |
| 8-29mm       | ±1.0mm  |
| 30-49mm      | ±2.0mm  |
| 50-69mm      | ±3.0mm  |
| 70-100mm     | ±4.0mm  |
| OVER 100mm   | ±5.0mm  |

NOTES:

1. "\*" INDICATES LEAD LENGTH IN METERS. CONTACT TURCK TO ORDER SPECIFIC LENGTHS.

SOURCE DRAWING - FOR REFERENCE ONLY

|   |   |   |                  |   |                                       |
|---|---|---|------------------|---|---------------------------------------|
| RELATED DOCUMENTS<br>1.<br>2.<br>3.<br>4. | 3RD ANGLE PROJECTION<br>  | THIS DRAWING IS PROPERTY OF TURCK INC. USE OF THIS DOCUMENT WITHOUT WRITTEN PERMISSION IS PROHIBITED. |                  | 3000 CAMPUS DRIVE<br>MINNEAPOLIS, MN 55441<br>1-800-544-7769<br>(763) 553-7300<br>(763) 553-0708 fax<br>turck.com |                                       |
|   |   | MATERIAL<br><br>SEE SPECIFICATIONS  | DRFT RDS<br>DSGN | DATE 12/07/07<br>SCALE 1=1.0  | DESCRIPTION<br>P-RKFV 101-*/14.75/NPT |
| FINISH<br><br>SEE SPECIFICATIONS          | ALL DIMENSIONS DISPLAYED ON THIS DRAWING ARE FOR REFERENCE ONLY<br><br>CONTACT TURCK FOR MORE INFORMATION | UNIT OF MEASUREMENT<br><b>MILLIMETER [ INCH ]</b>   |                  | IDENTIFICATION NO.  |                                       |
| DO NOT SCALE THIS DRAWING                 |   | FILE: 777020707   |                  | REV<br>A  |                                       |

|     |                 |     |          |         |
|-----|-----------------|-----|----------|---------|
| A   | DRAWING RELEASE | RDS | 12/07/07 |         |
| REV | DESCRIPTION     | BY  | DATE     | ECO NO. |