

BES 516-3017-G-E4-C-S4-00,2 BES00K7

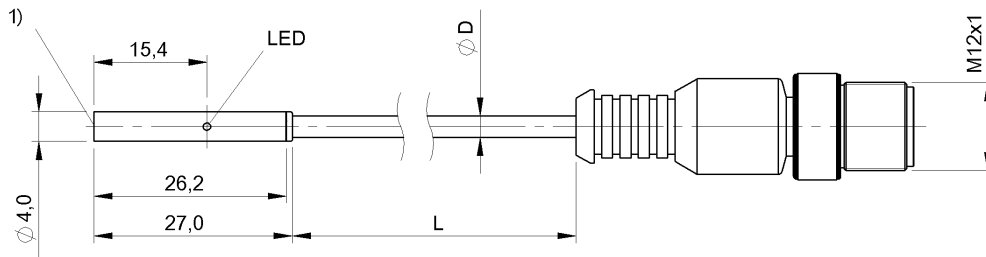

1) Sensing surface



IND. CONT. EQ
81U2
for use in the secondary of
a class 2 source of supply
Environmental - Type 1 Enclosure



Display/Operation

Function indicator	yes
Power indicator	no

Electrical connection

Cable diameter D	3.00 mm
Cable length	0.2 m
Connection	M12x1-Connector, 4-pole, A-coded
Connection type	Cable with connector, 0.20 m, PUR
Polarity reversal protected	yes
Short-circuit protection	yes

Electrical data

Hysteresis H max. (% of Sr)	15.0 %
Load capacitance max. at Ue	1 µF
No-load current I ₀ max., undamped	6 mA
Operating voltage U _b	10...30 VDC
Output resistance R _a	Open drain
Pollution degree	3
Protected against miswiring	yes
Rated insulation voltage U _i	75 V DC
Rated operating current I _e DC	100 mA
Rated operating voltage U _e DC	24 V
Rated short circuit current	100 A
Ready delay t _v max.	21 ms
Repeat accuracy max. (% of Sr)	5.0 %
Residual current I _r max.	10 µA
Switching frequency	5000 Hz
Utilization category	DC -13
Voltage drop static max.	2 V

Environmental conditions

Ambient temperature	-25...70 °C
Protection type IEC 60529	IP67

General data

Approval/Conformity	CE cULus EAC
Basic standard	IEC 60947-5-2

Material

Housing material	Stainless steel
Material jacket	PUR
Material sensing surface	PBT

Mechanical data

Dimension	Ø 4 x 27 mm
Installation	for flush mounting
Size	D4.0

Output/Interface

Switching output	PNP Normally closed (NC)
------------------	--------------------------

Range/Distance

Assured operating distance S _a	1.21 mm
Range	1.5 mm
Rated operating distance S _n	1.5 mm
Ripple max. (% of U _e)	10 %

BES 516-3017-G-E4-C-S4-00,2
BES00K7

Switching distance marking ■■
Temperature drift max. (% of Sr) 10 %

Remarks

The sensor is functional again after the overload has been eliminated.

Connector view



Wiring Diagram

