



# QUALITY ENCLOSURES

[Home](#)   [Product Catalog](#)   [Representatives](#)   [Search](#)  
[Company Info](#)   [Distributors](#)   [What's New](#)   [Contact](#)

Accessories - Handles

## Non-Locking Latch Handle

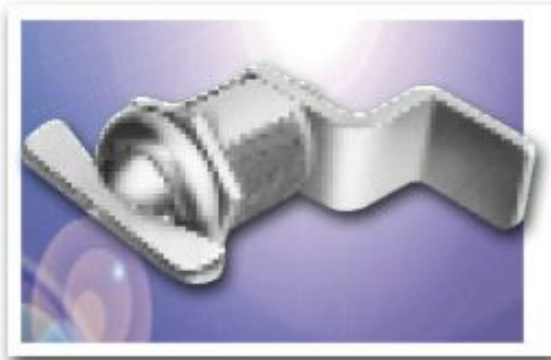

[Click on Image for Larger View](#)

### *Design Features*

Interchangeable with existing key lock. LH-9358 used on Series 60, Classic II, Series 2000, and Economizer Front and Rear Doors

Catalog Number	Drawings
LH-9358	<a href="#">PDF</a> <a href="#">DXF</a>

[DXF](#) Autocad DXF Specifications File  
(Requires CAD software such as AutoCAD)

[PDF](#) Adobe PDF Specifications File



[Download PDF Viewer](#)

[Home](#) | [Company Info](#) | [Online Catalog](#) | [Check Stock](#) | [Distributor/Price](#)

[Reps](#) | [New](#) | [Search](#) | [Contact](#) | [Privacy Policy](#)

### BUD INDUSTRIES INC.

P.O. Box 998  
Willoughby, Ohio 44094  
Phone: 440-946-3200 Fax: 440-951-4015  
E-Mail: [saleseast@budind.com](mailto:saleseast@budind.com)

PART  
NAME

SLIDE MOUNTING BRACKET

PART  
No.

BAS-5107

MATERIAL:

16 GA. STEEL

FINISH:

ZINC PLATED

QTY. (4) #5101 MOUNTING BRACKETS  
AND NECESSARY HARDWARE.

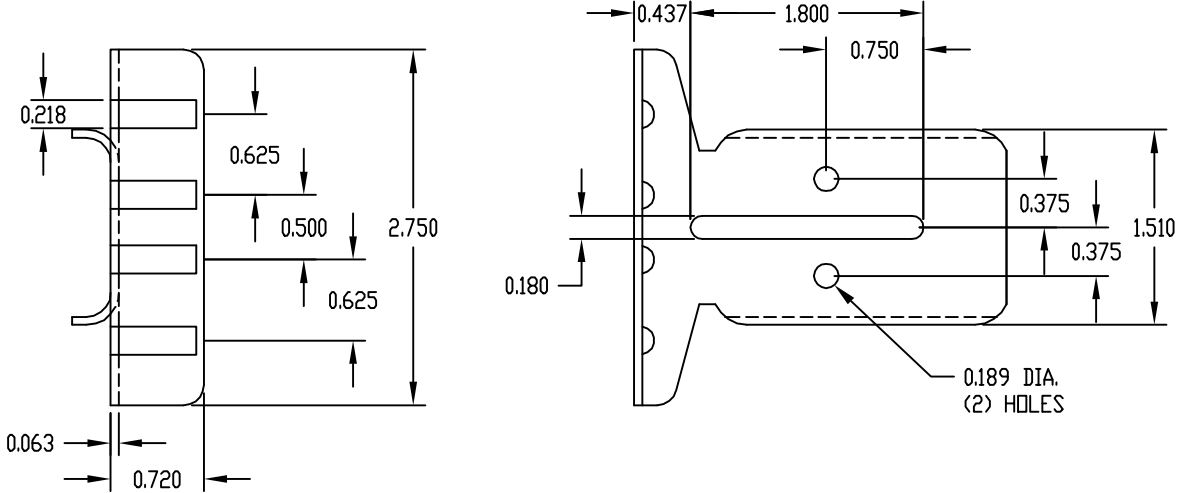
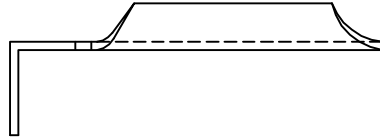

PART  
NAME

NON-LOCKING LATCH HANDLE ASSEMBLY

PART  
No.

LH-9358

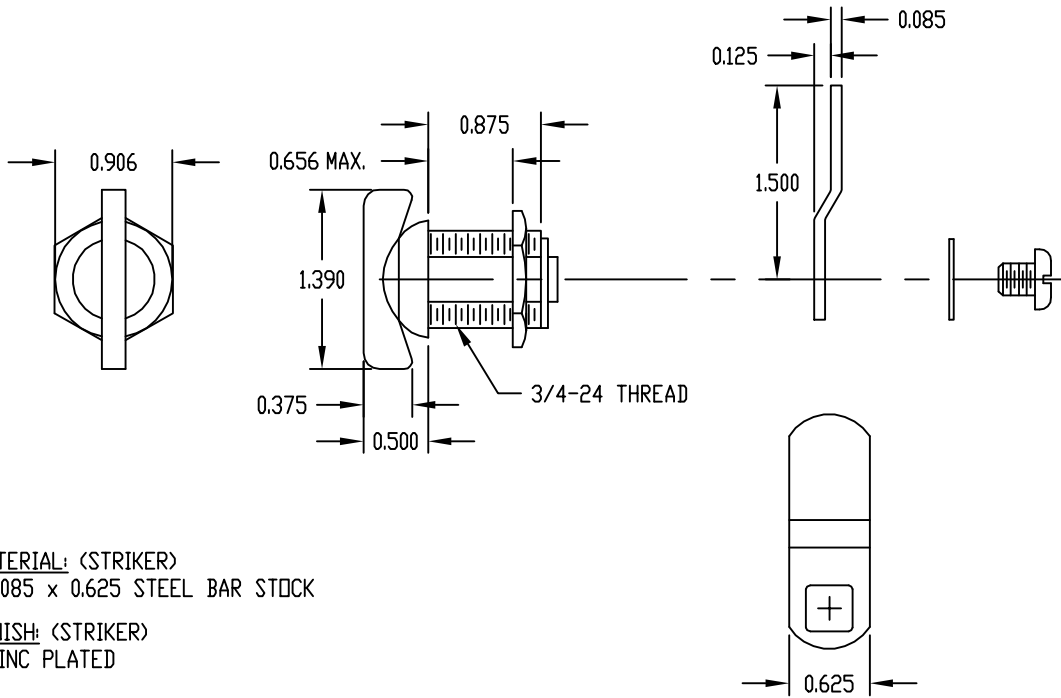

MATERIAL: (STRIKER)

0.085 x 0.625 STEEL BAR STOCK

FINISH: (STRIKER)

ZINC PLATED

USED ON: SERIES 60, SERIES 2000, ECONOMIZER REAR DOORS  
& ALL AMERICAN RACK FRONT & REAR DOORS.